

CLAYTON TOWNSHIP SECTION 17

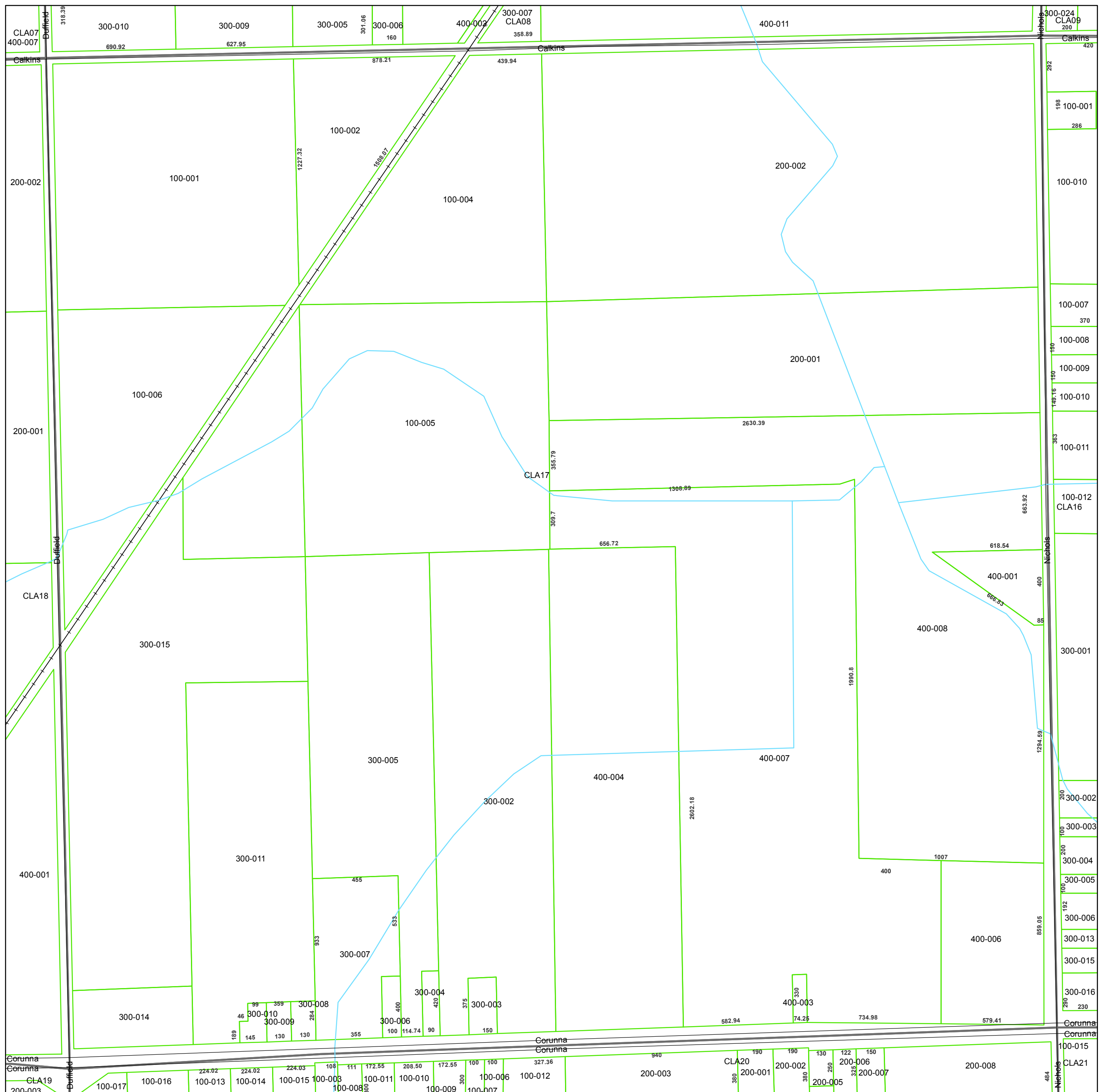

0 400
Feet

Parcel Information contained on this map is intended to serve as a representation of property records maintained by the Equalization Department and may or may not reflect actual parcel geometry

- Roads
- Lots
- Site Condominium
- Tracts
- Subdivison & Condominium Boundary
- Railroads
- Water

Location

